



TC263 SERIES

MF ISO metric fine threads DIN 13

Metrisches ISO-Feingewinde DIN 13
ISO MÉTRIQUE PAS FINS DIN13
ISO Metrico passo fine DIN 13

Machine taps
Maschinengewindebohrer

► Suitable for through hole in more cutting speed than other taps due to thick web.

► Geeignet für Durchgangslöcher in höherer Schnittgeschwindigkeit als bei anderen Gewindebohrern dank größerer Kerndicke.

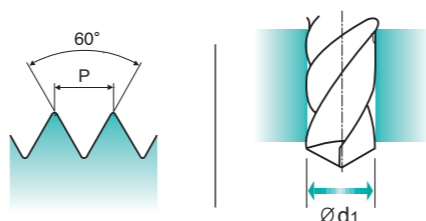
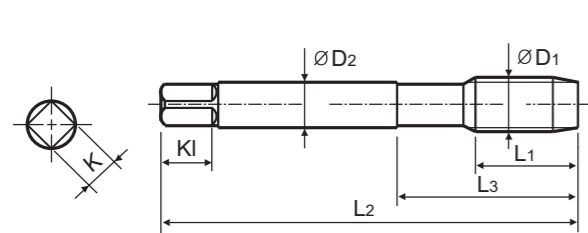

Material groups: **VG** HSS-E DIN 374 6H 60° B Bright p.B197

Recommended ToolHolder: Plain Shank TAPPING ER CHUCK D215-220 TAPPING CHUCK D221-228 ONE STEP TAPPING CHUCK D211-213

Unit : mm

SIZE	Pitch	EDP No.	Thread Length	Overall Length	Neck Length	Shank Diameter	Square Size	Square Length	No. of Flute	Tapping Drill Diameter
ØD1	P	Bright	L1	L2	L3	ØD2	K	K1	Z	Ød1
M4	× 0.5	TC263256	10	63	21	2.8	2.1	5	3	3.5
M5	× 0.5	TC263296	11	70	25	3.5	2.7	6	3	4.5
M6	× 0.75	TC263326	13	80	30	4.5	3.4	6	3	5.2
M6	× 0.5	TC263336	13	80	30	4.5	3.4	6	3	5.5
M7	× 0.75	TC263356	14	80	30	5.5	4.3	7	3	6.2
M8	× 1	TC263376	17	90	36	6	4.9	8	3	7
M8	× 0.75	TC263386	14	80	30	6	4.9	8	3	7.2
M10	× 1.25	TC263436	22	100	40	7	5.5	8	3	8.8
M10	× 1	TC263446	18	90	36	7	5.5	8	3	9
M10	× 0.75	TC263456	18	90	36	7	5.5	8	3	9.2
M12	× 1.5	TC263516	22	100	40	9	7	10	3	10.5
M12	× 1.25	TC263526	22	100	40	9	7	10	3	10.8
M12	× 1	TC263536	18	100	40	9	7	10	3	11
M14	× 1.5	TC263556	22	100	40	11	9	12	3	12.5
M14	× 1.25	TC263566	22	100	40	11	9	12	3	12.8
M16	× 1.5	TC263616	22	100	40	12	9	12	3	14.5
M18	× 1.5	TC263676	25	110	44	14	11	14	4	16.5
M20	× 1.5	TC263726	25	125	50	16	12	15	4	18.5
M22	× 1.5	TC263766	25	125	50	18	14.5	17	4	20.5
M24	× 1.5	TC263806	27	140	54	18	14.5	17	4	22.5

◎ : Excellent ○ : Good

ISO Material Description	P										M				K					
	Non-alloy steel					Low alloy steel					High alloyed steel, and tool steel		Stainless steel		Grey cast iron	Nodular cast iron	Malleable cast iron			
VDI 3323	1	2	3	4	5	6	7	8	9	10	11	12	13	14	15	16	17	18	19	20
HRc	13	25	28	32	30	10	29	32	38	15	35	15	23	10	10	26	3	25	21	21
HB	125	190	250	270	300	180	275	300	350	200	325	200	240	180	180	260	160	250	130	230
Recommended	○	○	○	◎	○	○	◎	◎	◎	○	○	○	○	○	○	○	○	○	○	○

ISO Material Description	N										S						H				
	Aluminum-wrought alloy		Aluminum-cast, alloyed			Copper and Copper Alloys (Bronze / Brass)					Non Metallic Materials		Heat Resistant Super Alloys				Titanium Alloys		Hardened steel	Chilled Cast Iron	Hardened Cast Iron
VDI 3323	21	22	23	24	25	26	27	28	29	30	31	32	33	34	35	36	37	38	39	40	41
HRc	21	22	23	24	25	26	27	28	29	30	15	30	25	38	34	55	60	42	42	55	55
HB	60	100	75	90	130	110	90	100			200	280	250	350	320	400Rm	1050Rm	550	630	400	550
Recommended	○	○	○	○	○	○	○	○	○	○	○	○	○	○	○	○	○	○	○	○	○



TD263 SERIES

MF ISO metric fine threads DIN 13

Metrisches ISO-Feingewinde DIN 13
ISO MÉTRIQUE PAS FINS DIN13
ISO Metrico passo fine DIN 13

Machine taps
Maschinengewindebohrer

► Suitable for through hole in more cutting speed than other taps due to thick web.

► Geeignet für Durchgangslöcher in höherer Schnittgeschwindigkeit als bei anderen Gewindebohrern dank größerer Kerndicke.

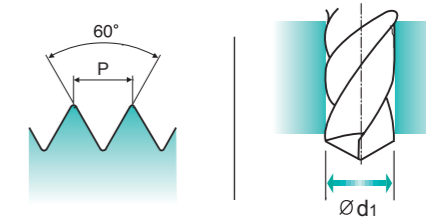
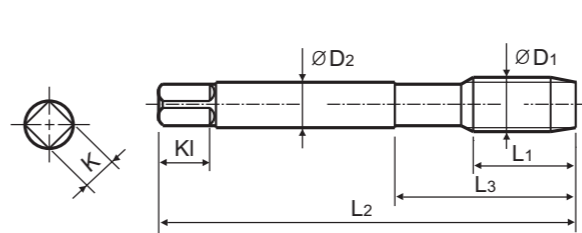

Material groups: **VG** HSS-E DIN 374 6H 60° B TiN p.B197

Recommended ToolHolder: Plain Shank TAPPING ER CHUCK D215-220 TAPPING CHUCK D221-228 ONE STEP TAPPING CHUCK D211-213

Unit : mm

SIZE	Pitch	EDP No.	Thread Length	Overall Length	Neck Length	Shank Diameter	Square Size	Square Length	No. of Flute	Tapping Drill Diameter
ØD1	P	TiN	L1	L2	L3	ØD2	K	K1	Z	Ød1
M4	× 0.5	TD263256	10	63	21	2.8	2.1	5	3	3.5
M5	× 0.5	TD263296	11	70	25	3.5	2.7	6	3	4.5
M6	× 0.75	TD263326	13	80	30	4.5	3.4	6	3	5.2
M6	× 0.5	TD263336	13	80	30	4.5	3.4	6	3	5.5
M7	× 0.75	TD263356	14	80	30	5.5	4.3	7	3	6.2
M8	× 1	TD263376	17	90	36	6	4.9	8	3	7
M8	× 0.75	TD263386	14	80	30	6	4.9	8	3	7.2
M10	× 1.25	TD263436	22	100	40	7	5.5	8	3	8.8
M10	× 1	TD263446	18	90	36	7	5.5	8	3	9
M10	× 0.75	TD263456	18	90	36	7	5.5	8	3	9.2
M12	× 1.5	TD263516	22	100	40	9	7	10	3	10.5
M12	× 1.25	TD263526	22	100	40	9	7	10	3	10.8
M12	× 1	TD263536	18	100	40	9	7	10	3	11
M14	× 1.5	TD263556	22	100	40	11	9	12	3	12.5
M14	× 1.25	TD263566	22	100	40	11	9	12	3	12.8
M16	× 1.5	TD263616	22	100	40	12	9	12	3	14.5
M18	× 1.5	TD263676	25	110	44	14	11	14	4	16.5
M20	× 1.5	TD263726	25	125	50	16	12	15	4	18.5
M22	× 1.5	TD263766	25	125	50	18	14.5	17	4	20.5
M24	× 1.5	TD263806	27	140	54	18	14.5	17	4	22.5

◎ : Excellent ○ : Good

ISO Material Description	P										M				K					
	Non-alloy steel					Low alloy steel					High alloyed steel, and tool steel		Stainless steel		Grey cast iron	Nodular cast iron	Malleable cast iron			
VDI 3323	1	2	3	4	5	6	7	8	9	10	11	12	13	14	15	16	17	18	19	20
HRc	13	25	28	32	30	10	29	32	38	15	35	15	23	10	10	26	3	25	21	21
HB	125	190	250	270	300	180	275	300	350	200	325	200	240	180	180	260	160	250	130	230
Recommended	○	○	○	◎	○	○	◎	◎	◎	○	○	○	○	○	○	○	○	○	○	○

ISO Material Description	N										S						H				
	Aluminum-wrought alloy		Aluminum-cast, alloyed			Copper and Copper Alloys (Bronze / Brass)					Non Metallic Materials		Heat Resistant Super Alloys				Titanium Alloys		Hardened steel	Chilled Cast Iron	Hardened Cast Iron
VDI 3323	21	22	23	24	25	26	27	28	29	30	31	32	33	34	35	36	37	38	39	40	41
HRc	21	22	23	24	25	26	27	28	29	30	15	30	25	38	34	55	60	42	42	55	55
HB	60	100	75	90	130	110	90	100			200	280	250	350	320	400Rm	1050Rm	550	630	400	550
Recommended	○	○	○	○	○	○	○	○	○	○	○	○	○	○	○	○	○	○	○	○	○