

SELECTION GUIDE



HSS-E SCREW THREAD INSERT TAPS

Tapping STI Threads of Soft Materials



Please visit globaly1.com/mat for material search

◎ : Excellent ○ : Good

Recommended cutting conditions : p.B306

Table with columns: ISO, VDI 3323, Material Description, Composition / Structure / Heat Treatment, HB, HRc, and MODEL. It lists various materials like Non-alloy steel, Low alloy steel, Stainless steel, Grey cast iron, etc., and their corresponding HSS-E tap models (e.g., TC909, TC944, TC973).

YG SCREW THREAD INSERT TAPS

TC909 SERIES

EG-M ISO metric coarse threads for Screw Thread insert. Includes text in German: 'Metrisches ISO Regelgew.f.Gew. Drahteins' and 'ISO MÉTRIQUE DIN13 POUR FILETS RAPPORTÉS'.

Wire insert threads are used for increasing fastening strength in soft materials.

Gewinde mit Drahteinsätzen werden verwendet um größere Drehmomente in weichen Werkstoffen zu erreichen.

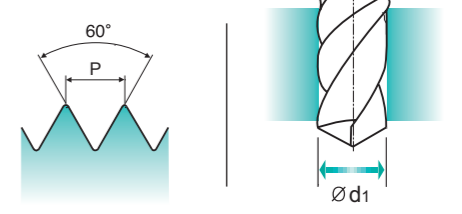
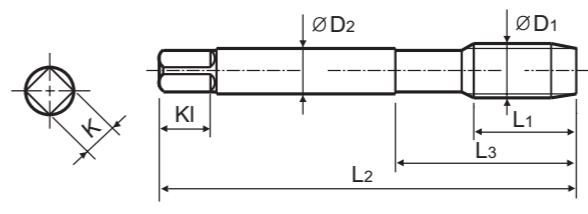
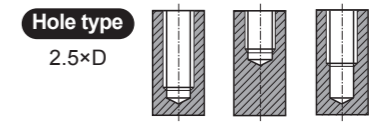

Material groups: AI, HSS-E, DIN 371/376, 6H Mod., 60°, C, R40, Bright, p.B306. Includes a Recommended Toolholder icon and page information.

Recommended Cutting Page : P.298

Table with columns: SIZE, Pitch, EDP No., Thread Length, Overall Length, Neck Length, Shank Diameter, Square Size, Square Length, No. of Flute, Tapping Drill Diameter. Lists various sizes from M2.5 x 0.45 to M20 x 2.5.

DIN 371(M2.5~M8) and DIN 376(M10~M20)

◎ : Excellent ○ : Good

Summary table with columns for Material Description, ISO, and various material groups (P, M, K, N, S, H) with their respective HB and HRc values.