



TC413 SERIES

**MF** ISO metric fine threads DIN 13  
 ● Metrisches ISO-Feingewinde DIN 13  
 ○ ISO MÉTRIQUE PAS FINS DIN13  
 ○ ISO Metrico passo grosso DIN 13

Machine taps  
Maschinengewindebohrer

► Suitable for tapping blind holes due to special flute geometry and excellent chip evacuation.

► Geeignet zum Gewinden von Sacklöchern dank besonderer Nutengeometrie und ausgezeichneter Spanabfuhr.

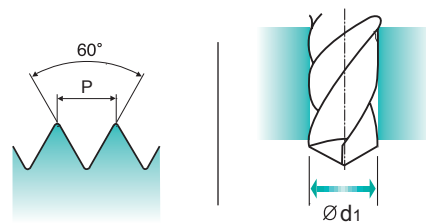
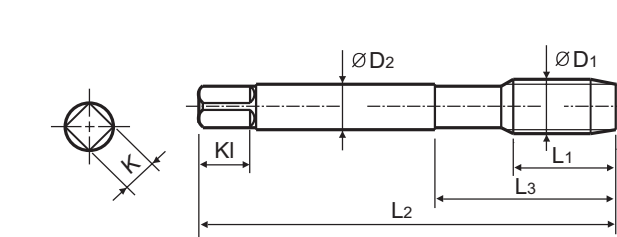
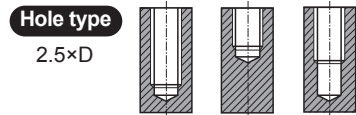

**VG** HSS-E DIN 374 6H 60° C R40 Bright p.B197

Plain Shank Page D215-220  
TAPPING ER CHUCK D221-228  
Recommended ToolHolder ONE STEP TAPPING CHUCK D211-213

Unit : mm

SIZE	Pitch	EDP No.	Thread Length	Overall Length	Neck Length	Shank Diameter	Square Size	Square Length	No. of Flute	Tapping Drill Diameter
ØD1	P	Bright	L1	L2	L3	ØD2	K	Kl	Z	Ød1
M4	× 0.5	TC413256	5	63	21	2.8	2.1	5	3	3.5
M5	× 0.5	TC413296	5	70	25	3.5	2.7	6	3	4.5
M6	× 0.75	TC413326	8	80	30	4.5	3.4	6	3	5.2
M6	× 0.5	TC413336	5	80	30	4.5	3.4	6	3	5.5
M7	× 0.75	TC413356	10	80	30	5.5	4.3	7	3	6.2
M8	× 1	TC413376	10	90	36	6	4.9	8	3	7
M8	× 0.75	TC413386	8	80	30	6	4.9	8	3	7.2
M10	× 1.25	TC413436	16	100	40	7	5.5	8	3	8.8
M10	× 1	TC413446	10	90	36	7	5.5	8	3	9
M10	× 0.75	TC413456	10	90	36	7	5.5	8	3	9.2
M12	× 1.5	TC413516	15	100	40	9	7	10	3	10.5
M12	× 1.25	TC413526	15	100	40	9	7	10	3	10.8
M12	× 1	TC413536	11	100	40	9	7	10	3	11
M14	× 1.5	TC413556	15	100	40	11	9	12	3	12.5
M14	× 1.25	TC413566	15	100	40	11	9	12	3	12.8
M16	× 1.5	TC413616	15	100	40	12	9	12	3	14.5
M18	× 1.5	TC413676	17	110	44	14	11	14	4	16.5
M20	× 1.5	TC413726	17	125	50	16	12	15	4	18.5
M22	× 1.5	TC413766	17	125	50	18	14.5	17	4	20.5
M24	× 1.5	TC413806	20	140	54	18	14.5	17	4	22.5

◎ : Excellent ○ : Good

ISO Material Description	P					M					K									
	Non-alloy steel					Low alloy steel					High alloyed steel, and tool steel									
VDI 3323	1	2	3	4	5	6	7	8	9	10	11	12	13	14	15	16	17	18	19	20
HRc	13	25	28	32	30	10	29	32	38	15	35	15	23	10	10	26	3	25	21	21
HB	125	190	250	270	300	180	275	300	350	200	325	200	240	180	180	260	160	250	130	230
Recommended	○	○	○	◎	○	○	◎	◎	◎	○	○	○	○	○	○	○	○	○	○	○

ISO Material Description	N					S					H										
	Aluminum-wrought alloy					Copper and Copper Alloys (Bronze / Brass)					Non Metallic Materials										
VDI 3323	21	22	23	24	25	26	27	28	29	30	31	32	33	34	35	36	37	38	39	40	41
HRc											15	30	25	38	34			55	60	42	55
HB	60	100	75	90	130	110	90	100			200	280	250	350	320	400Rm	1050Rm	550	630	400	550
Recommended											○	○	○	○	○	○	○	○	○	○	○



TD413 SERIES

**MF** ISO metric fine threads DIN 13  
 ● Metrisches ISO-Feingewinde DIN 13  
 ○ ISO MÉTRIQUE PAS FINS DIN13  
 ○ ISO Metrico passo grosso DIN 13

Machine taps  
Maschinengewindebohrer

► Suitable for tapping blind holes due to special flute geometry and excellent chip evacuation.

► Geeignet zum Gewinden von Sacklöchern dank besonderer Nutengeometrie und ausgezeichneter Spanabfuhr.

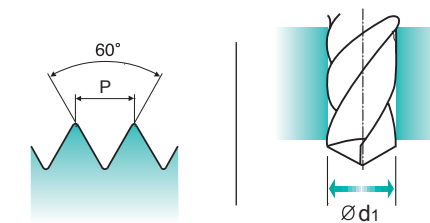
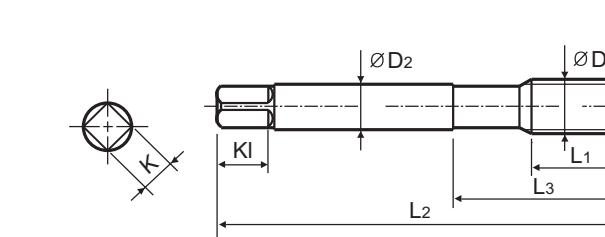
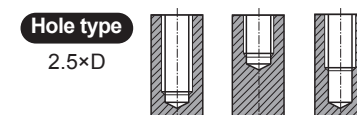

**VG** HSS-E DIN 374 6H 60° C R40 TiN p.B197

Plain Shank Page D215-220  
TAPPING ER CHUCK D221-228  
Recommended ToolHolder ONE STEP TAPPING CHUCK D211-213

Unit : mm

SIZE	Pitch	EDP No.	Thread Length	Overall Length	Neck Length	Shank Diameter	Square Size	Square Length	No. of Flute	Tapping Drill Diameter
ØD1	P	TiN	L1	L2	L3	ØD2	K	Kl	Z	Ød1
M4	× 0.5	TD413256	5	63	21	2.8	2.1	5	3	3.5
M5	× 0.5	TD413296	5	70	25	3.5	2.7	6	3	4.5
M6	× 0.75	TD413326	8	80	30	4.5	3.4	6	3	5.2
M6	× 0.5	TD413336	5	80	30	4.5	3.4	6	3	5.5
M7	× 0.75	TD413356	10	80	30	5.5	4.3	7	3	6.2
M8	× 1	TD413376	10	90	36	6	4.9	8	3	7
M8	× 0.75	TD413386	8	80	30	6	4.9	8	3	7.2
M10	× 1.25	TD413436	16	100	40	7	5.5	8	3	8.8
M10	× 1	TD413446	10	90	36	7	5.5	8	3	9
M10	× 0.75	TD413456	10	90	36	7	5.5	8	3	9.2
M12	× 1.5	TD413516	15	100	40	9	7	10	3	10.5
M12	× 1.25	TD413526	15	100	40	9	7	10	3	10.8
M12	× 1	TD413536	11	100	40	9	7	10	3	11
M14	× 1.5	TD413556	15	100	40	11	9	12	3	12.5
M14	× 1.25	TD413566	15	100	40	11	9	12	3	12.8
M16	× 1.5	TD413616	15	100	40	12	9	12	3	14.5
M18	× 1.5	TD413676	17	110	44	14	11	14	4	16.5
M20	× 1.5	TD413726	17	125	50	16	12	15	4	18.5
M22	× 1.5	TD413766	17	125	50	18	14.5	17	4	20.5
M24	× 1.5	TD413806	20	140	54	18	14.5	17	4	22.5

◎ : Excellent ○ : Good

ISO Material Description	P					M					K									
	Non-alloy steel					Low alloy steel					High alloyed steel, and tool steel									
VDI 3323	1	2	3	4	5	6	7	8	9	10	11	12	13	14	15	16	17	18	19	20
HRc	13	25	28	32	30	10	29	32	38	15	35	15	23	10	10	26	3	25	21	21
HB	125	190	250	270	300	180	275	300	350	200	325	200	240	180	180	260	160	250	130	230
Recommended	○	○	○	◎	○	○	◎	◎	◎	○	○	○	○	○	○	○	○	○	○	○

ISO Material Description	N					S					H										
	Aluminum-wrought alloy					Copper and Copper Alloys (Bronze / Brass)					Non Metallic Materials										
VDI 3323	21	22	23	24	25	26	27	28	29	30	31	32	33	34	35	36	37	38	39	40	41
HRc											15	30	25	38	34			55	60	42	55
HB	60	100	75	90	130	110	90	100			200	280	250	350	320	400Rm	1050Rm	550	630	400	550
Recommended											○	○	○	○	○	○	○	○	○	○	○