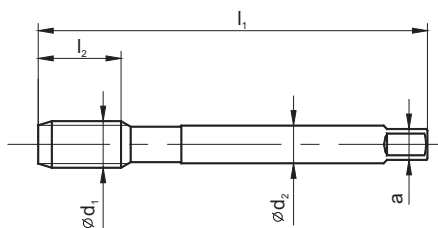

1

**Gwint metryczny drobnozwojny
ISO DIN-13**

HSSE

DIN
374

800

C

B

C-R40



Rodzaj materiału obrabianego

P

M

K

N

S

H

P

M

K

N

S

H

P

M

K

N

S

H

Typ otworu



Rodzaj materiału

HSSE

HSSE

HSSE

Rodzaj powłoki

Nakrój

C / 2-3P

B / 4-5P

C / 2-3P

MF $\varnothing d_1$	P	l_1	l_2	l_2 R40 R45	l_3	$\varnothing d_2$	a		Norma			DIN-374			
									Tol.	ISO2 (6H)		Tol.	ISO2 (6H)		
										INDEX	D2-121101		D2-111101	D2-511101	D2-121101
M8x1	1,00	90	20	10	-	6,0	4,9	7,00	0083	●	●	●			
M9x1	1,00	90	20	10	-	7,0	5,5	8,00	0093	○	○	○			
M10x0,75	0,75	90	18	10	-	7,0	5,5	9,20	0102	●	●	●			
M10x1	1,00	90	20	10	-	7,0	5,5	9,00	0103	●	●	●			
M10x1,25	1,25	100	20	15	-	7,0	5,5	8,80	0104	●	●	●			
M11x1	1,00	90	20	10	-	8,0	6,2	10,00	0113	○	○	○			
M12x1	1,00	100	20	10	-	9,0	7,0	11,00	0123	●	●	●			
M12x1,25	1,25	100	20	15	-	9,0	7,0	10,80	0124	●	●	●			
M12x1,5	1,50	100	20	15	-	9,0	7,0	10,50	0125	●	●	●			
M14x1	1,00	100	20	10	-	11,0	9,0	13,00	0143	●	●	●			
M14x1,25	1,25	100	20	15	-	11,0	9,0	12,80	0144	●	●	●			
M14x1,5	1,50	100	20	15	-	11,0	9,0	12,50	0145	●	●	●			
M15x1	1,00	100	20	10	-	12,0	9,0	14,00	0153	○	○	○			
M16x1	1,00	100	20	10	-	12,0	9,0	15,00	0163	●	●	●			
M16x1,5	1,50	100	20	15	-	12,0	9,0	14,50	0165	●	●	●			
M18x1	1,00	110	24	13	-	14,0	11,0	17,00	0183	○	○	○			
M18x1,5	1,50	110	24	17	-	14,0	11,0	16,50	0185	●	●	●			
M18x2	2,00	125	27	20	-	14,0	11,0	16,00	0186	●	●	●			
M20x1	1,00	125	24	13	-	16,0	12,0	19,00	0203	○	○	○			
M20x1,5	1,50	125	24	17	-	16,0	12,0	18,50	0205	●	●	●			
M20x2	2,00	140	27	20	-	16,0	12,0	18,00	0206	●	●	●			
M22x1	1,00	125	24	13	-	18,0	14,5	21,00	0223	○	○	○			
M22x1,5	1,50	125	24	17	-	18,0	14,5	20,50	0225	●	●	●			
M22x2	2,00	140	27	20	-	18,0	14,5	20,00	0226	●	●	●			
M24x1	1,00	140	27	13	-	18,0	14,5	23,00	0243	○	○	○			
M24x1,5	1,50	140	27	20	-	18,0	14,5	22,50	0245	●	●	●			
M24x2	2,00	140	27	20	-	18,0	14,5	22,00	0246	●	●	●			
M25x1,5	1,50	140	27	20	-	18,0	14,5	23,50	0255	○	○	○			
M26x1,5	1,50	140	27	20	-	18,0	14,5	24,50	0265	○	○	○			
M27x1,5	1,50	140	27	20	-	20,0	16,0	25,50	0275	●	●	●			
M27x2	2,00	140	27	20	-	20,0	16,0	25,00	0276	●	●	●			
M28x1,5	1,50	140	27	20	-	20,0	16,0	26,50	0285	○	○	○			

● Dostępne z magazynu

○ Na zapytanie

ISO	Vc (m/min)		
P	5-20	5-20	5-20
M	5-10	5-10	5-10
K	5-15	5-15	5-15
N	5-25	5-25	5-25
S	-	-	-

Przykład zamówienia

D2-121101-0083

Gwintownik 800 M8x1-6H DIN-374 C HSSE